

MODELL: AN11

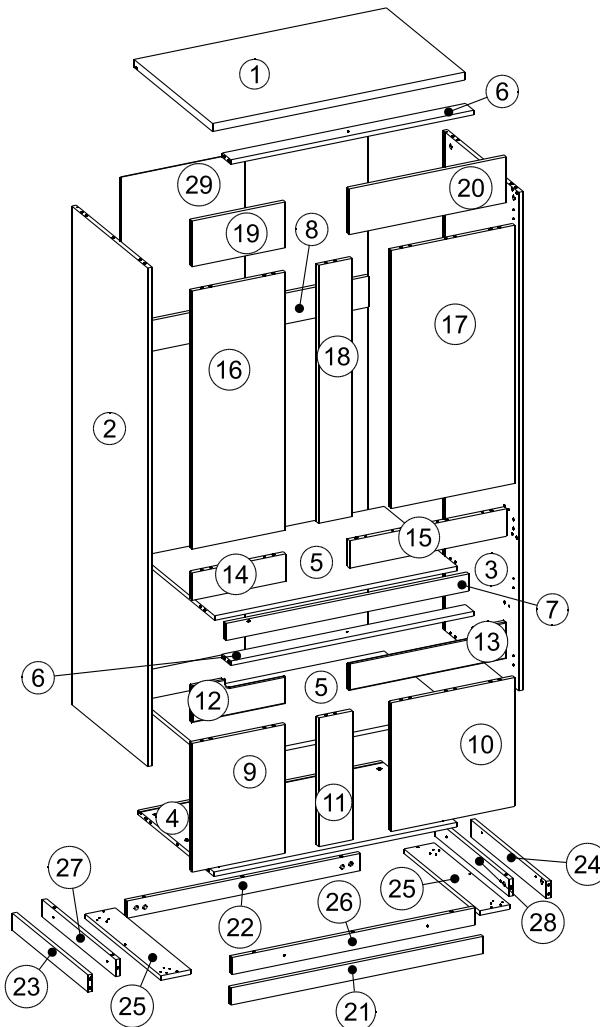

29	1741x882	2/3
28	524x60	2/3
27	524x60	2/3
26	866x60	2/3
25	540x108	2/3
24	540x60	2/3
23	540x60	2/3
22	833x60	2/3
21	900x60	2/3
20	560x160	3/3
19	333x160	3/3
18	902x120	3/3
17	440x902	3/3
16	333x902	3/3
15	560x96	3/3
14	333x96	3/3
13	560x128	3/3
12	333x128	3/3
11	450x120	3/3
10	440x450	3/3
9	333x450	3/3
8	866x108	2/3
7	866x60	2/3
6	866x60	2/3
5	866x523	1/3
4	866x541	1/3
3	1742x541	2/3
2	1742x541	2/3
1	900x560	1/3

1xLED ZT24800M		2x #14/151 ZN2																	
18x #20/151 ZN1		24x 3.5x16 W3		14x ST1		25x 8x50 K2		23x MK15/15 M3		14x 3x20 W9	10x ZC90		14x 4x30 W4		4x N1				
1x £1		36x 8x30 K1		1x L-859 D1		2x WS1		34x #15/15 M1		57x DU232T T1	16x 4x25 W8		8x 2x20 G1		3x 4x13 WP4				

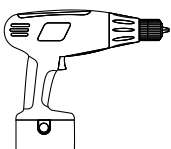
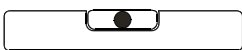
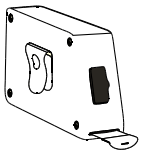
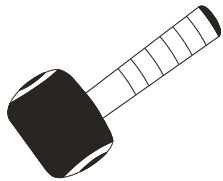
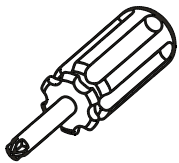
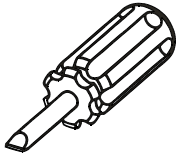
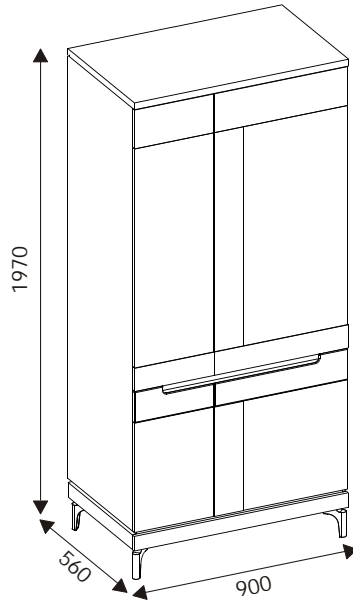
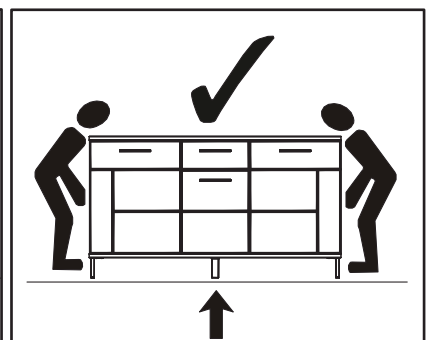
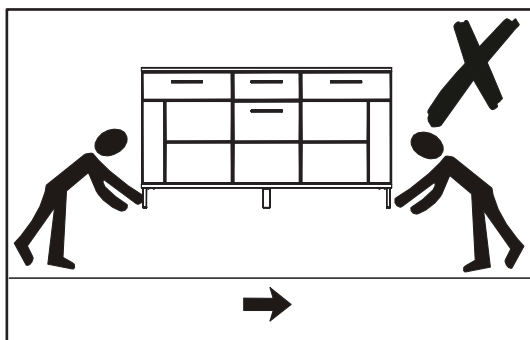
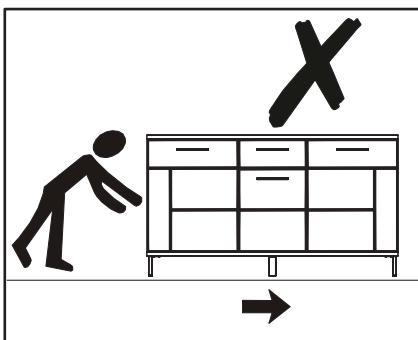
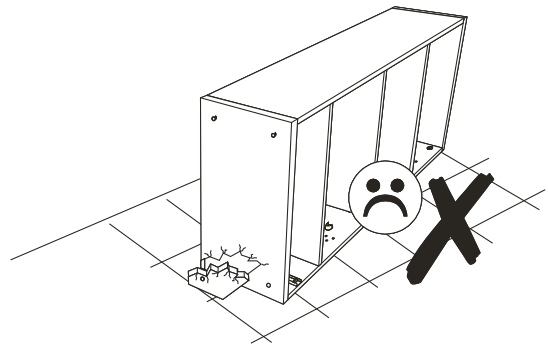
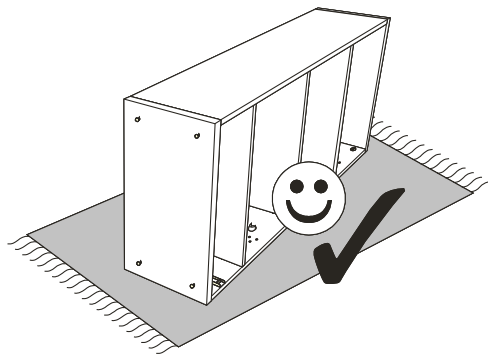
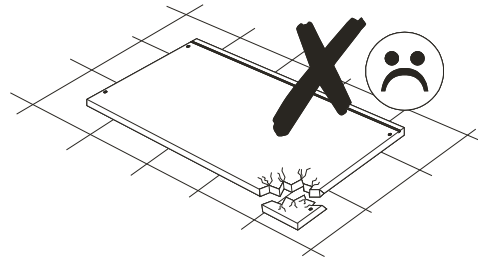
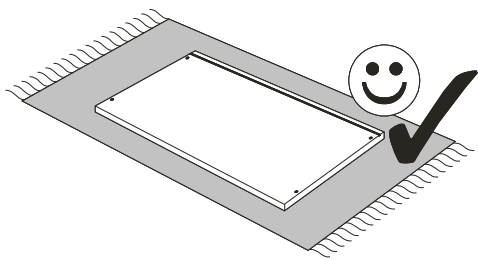
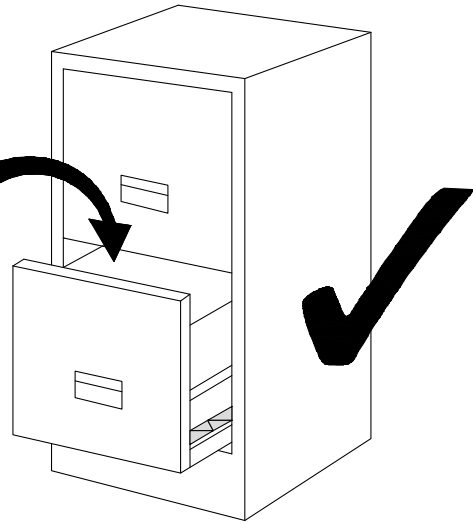
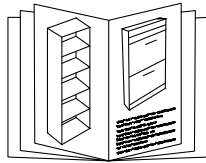
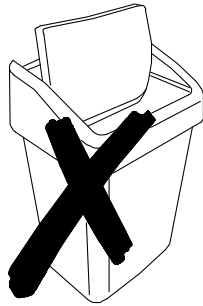

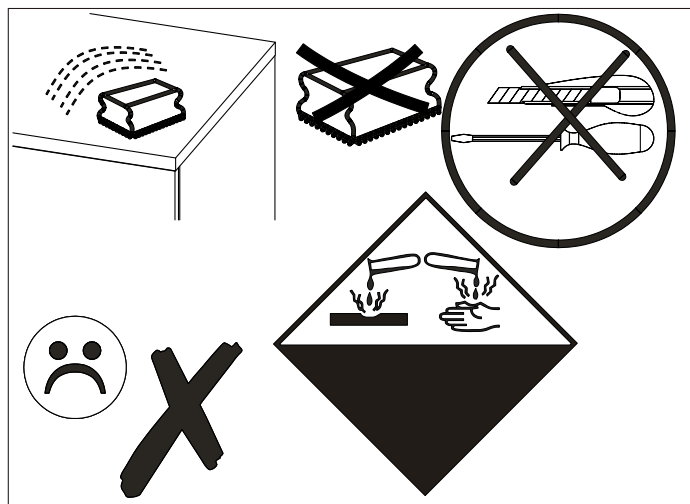
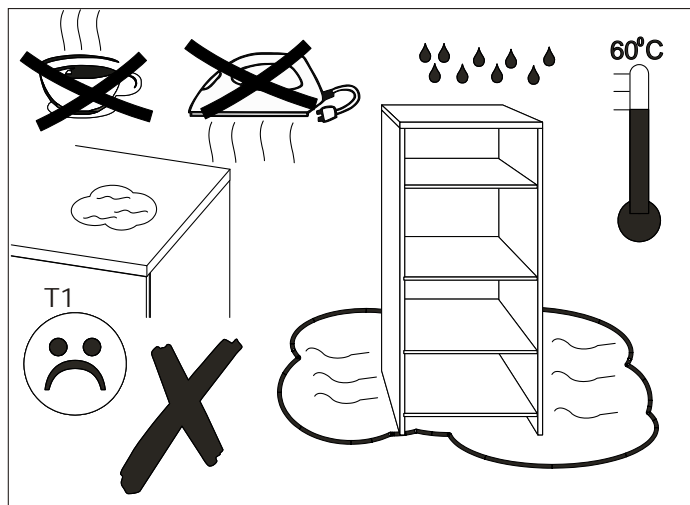
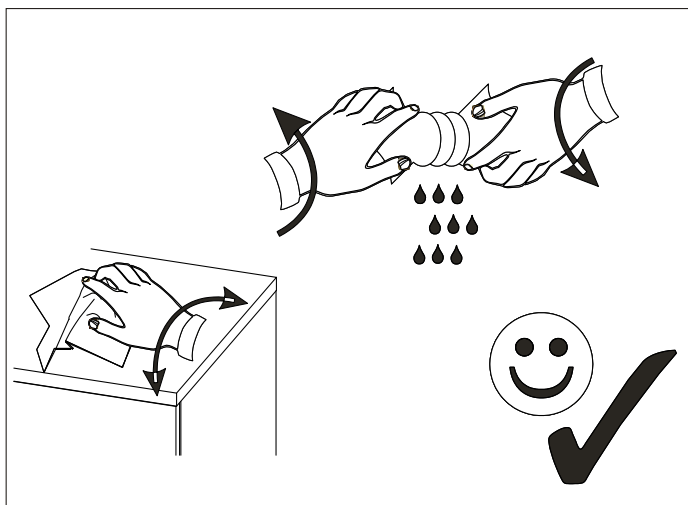
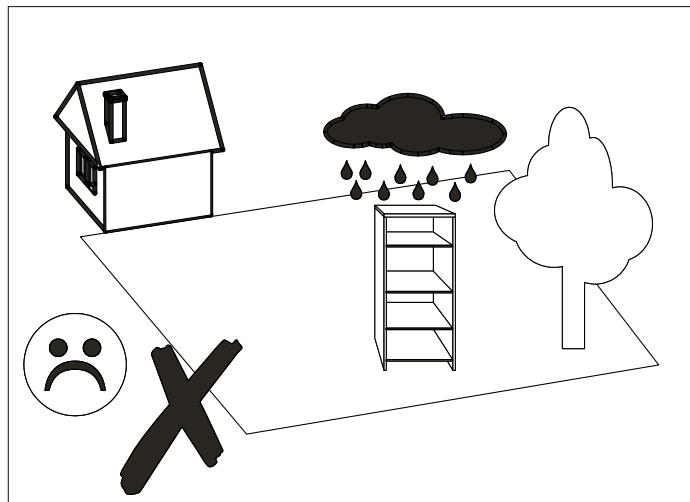
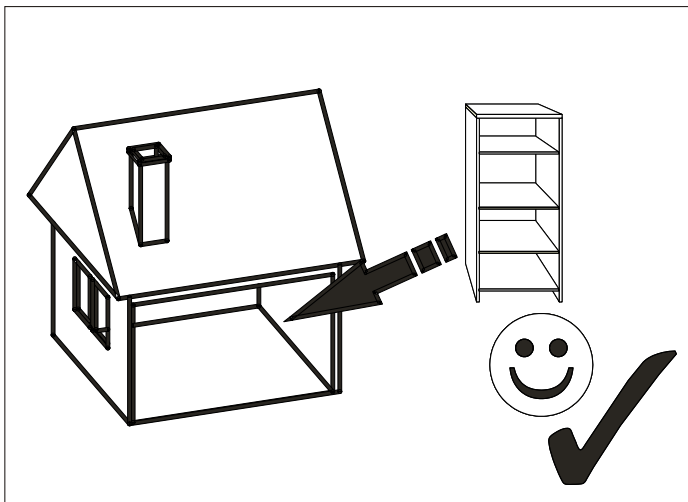

1 ▶

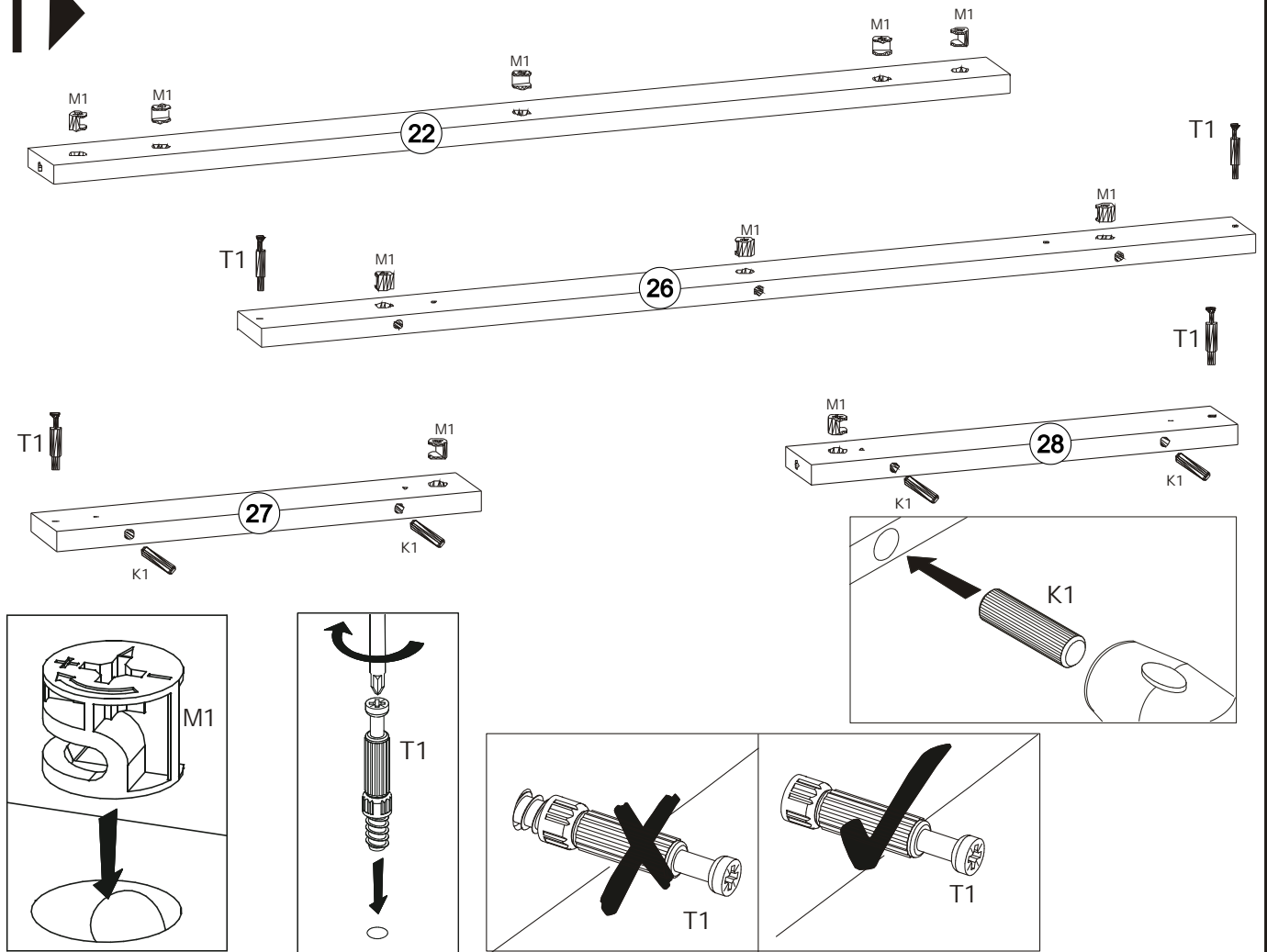

2 ▶

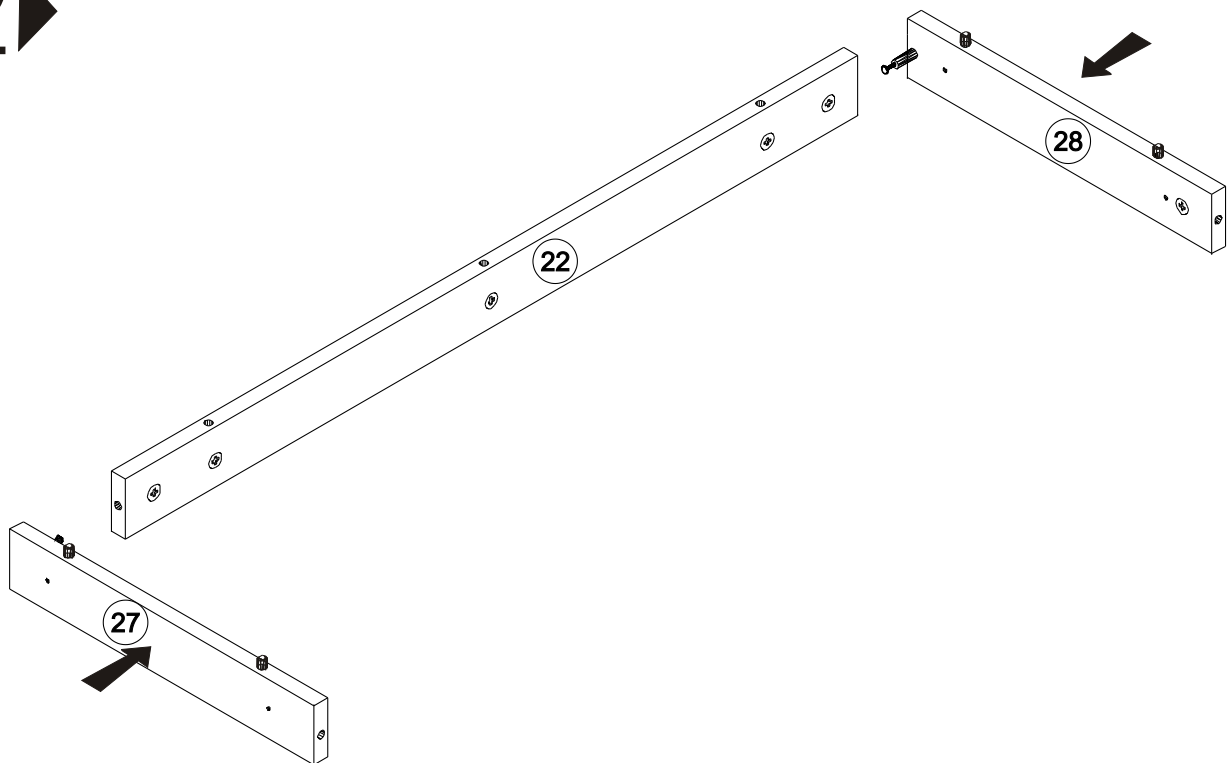

3 ▶

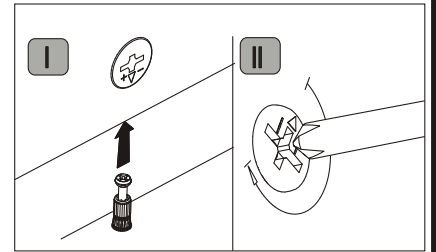
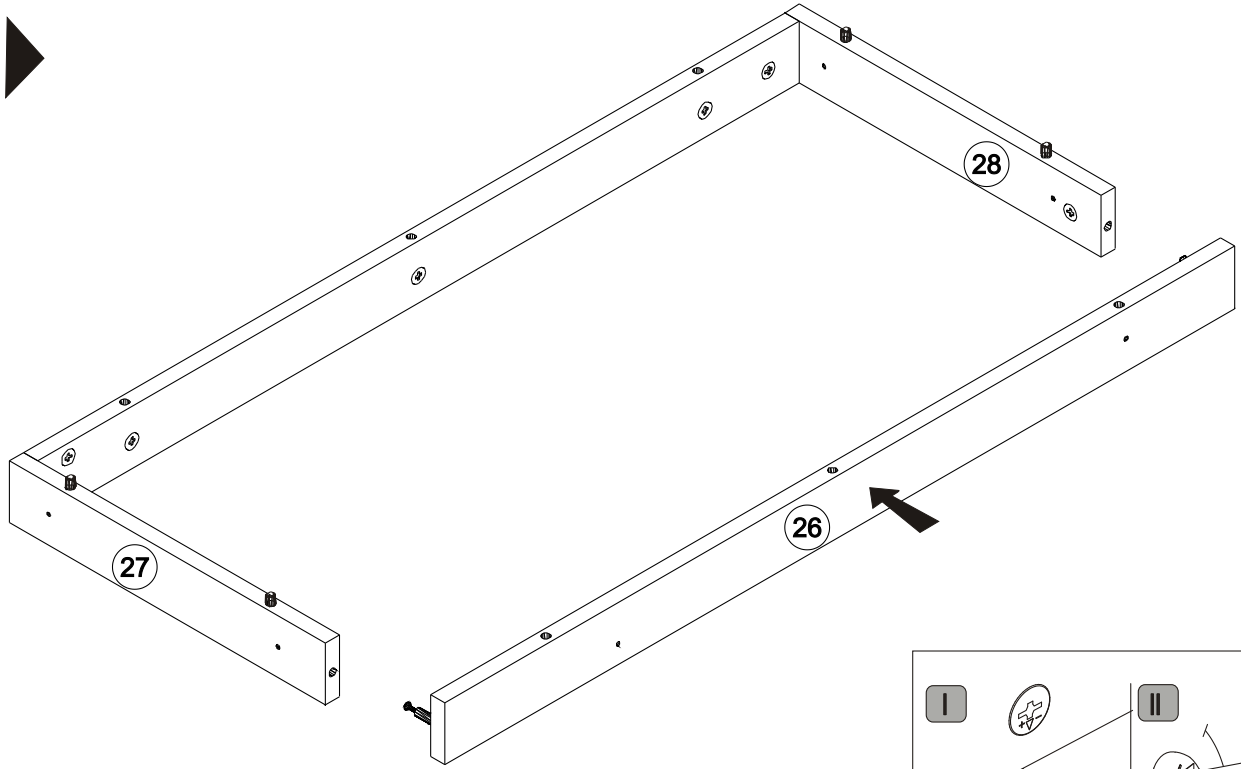

4 ▶

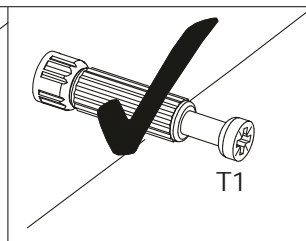
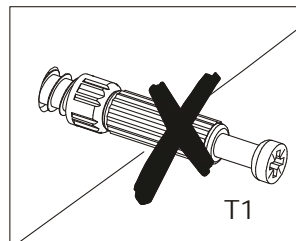
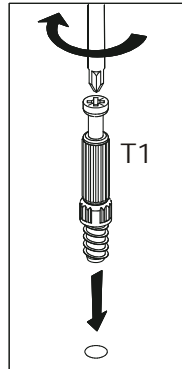
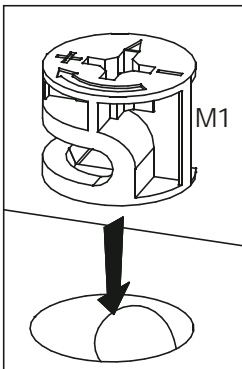
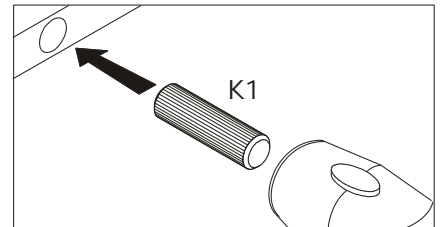
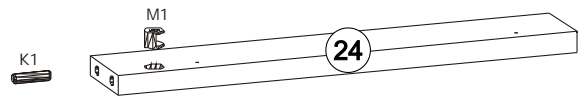
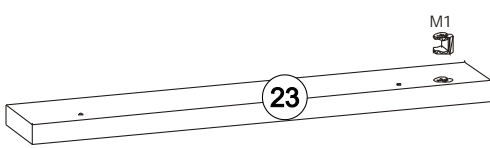
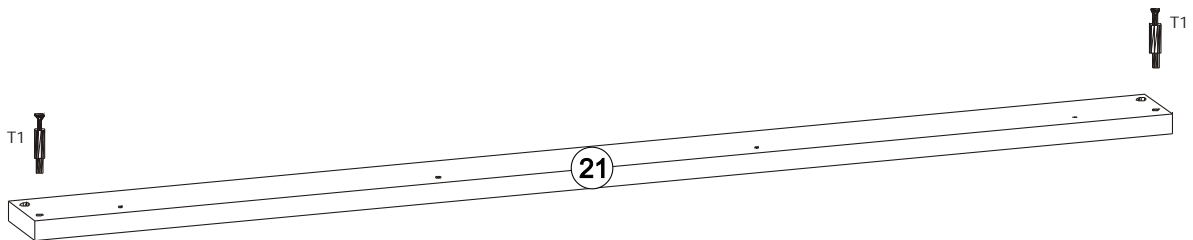

5 ▶

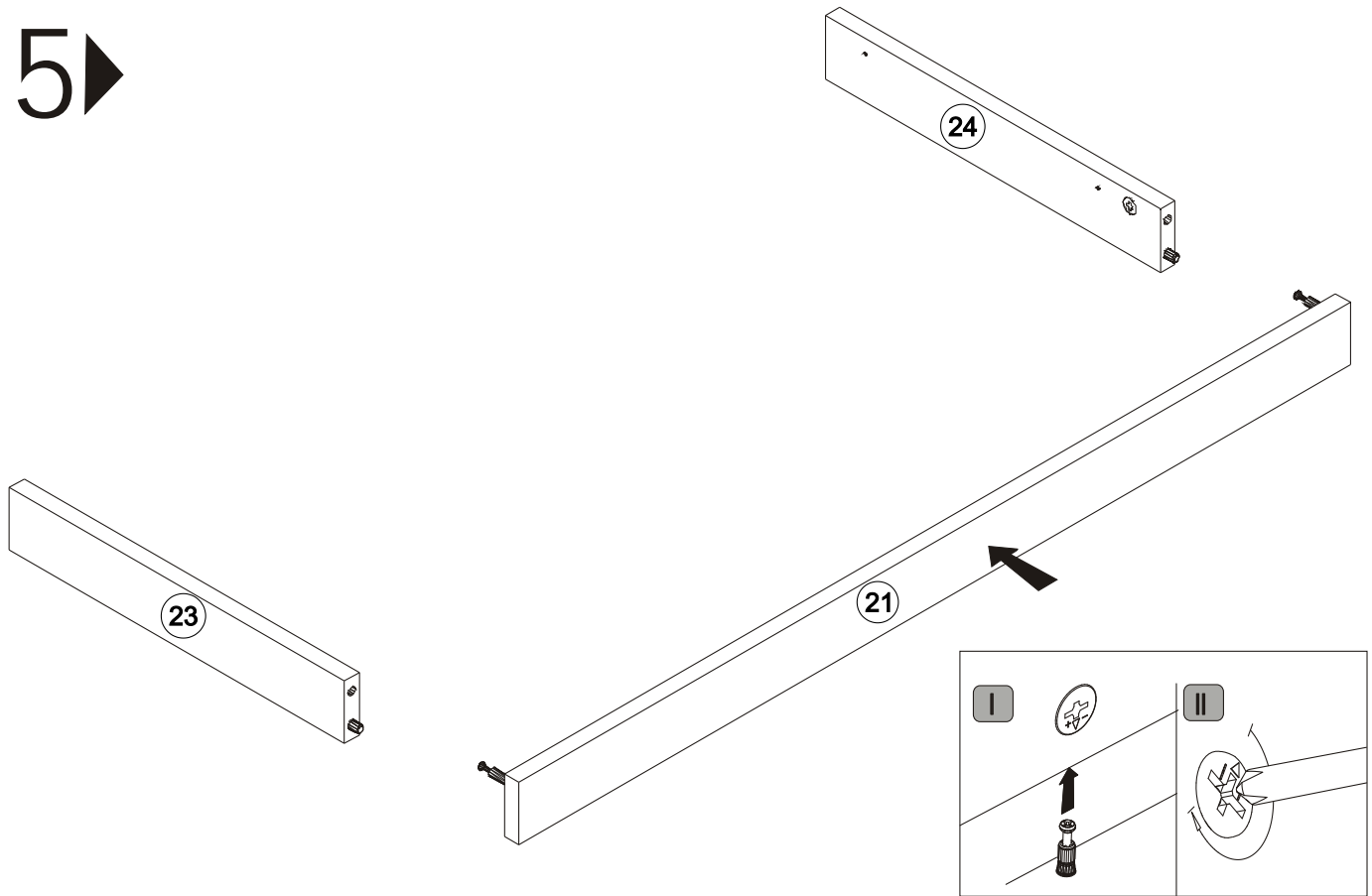

6 ▶

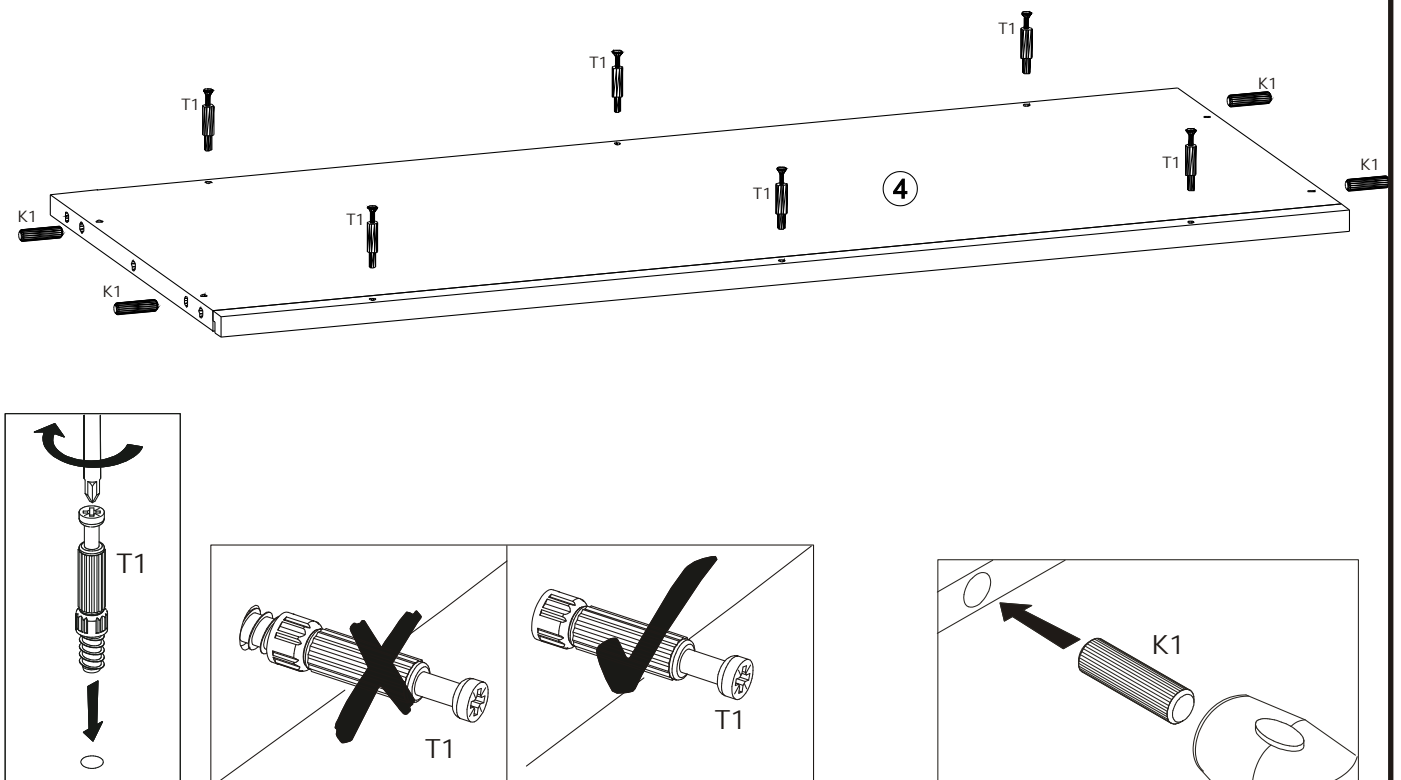

7 ▶

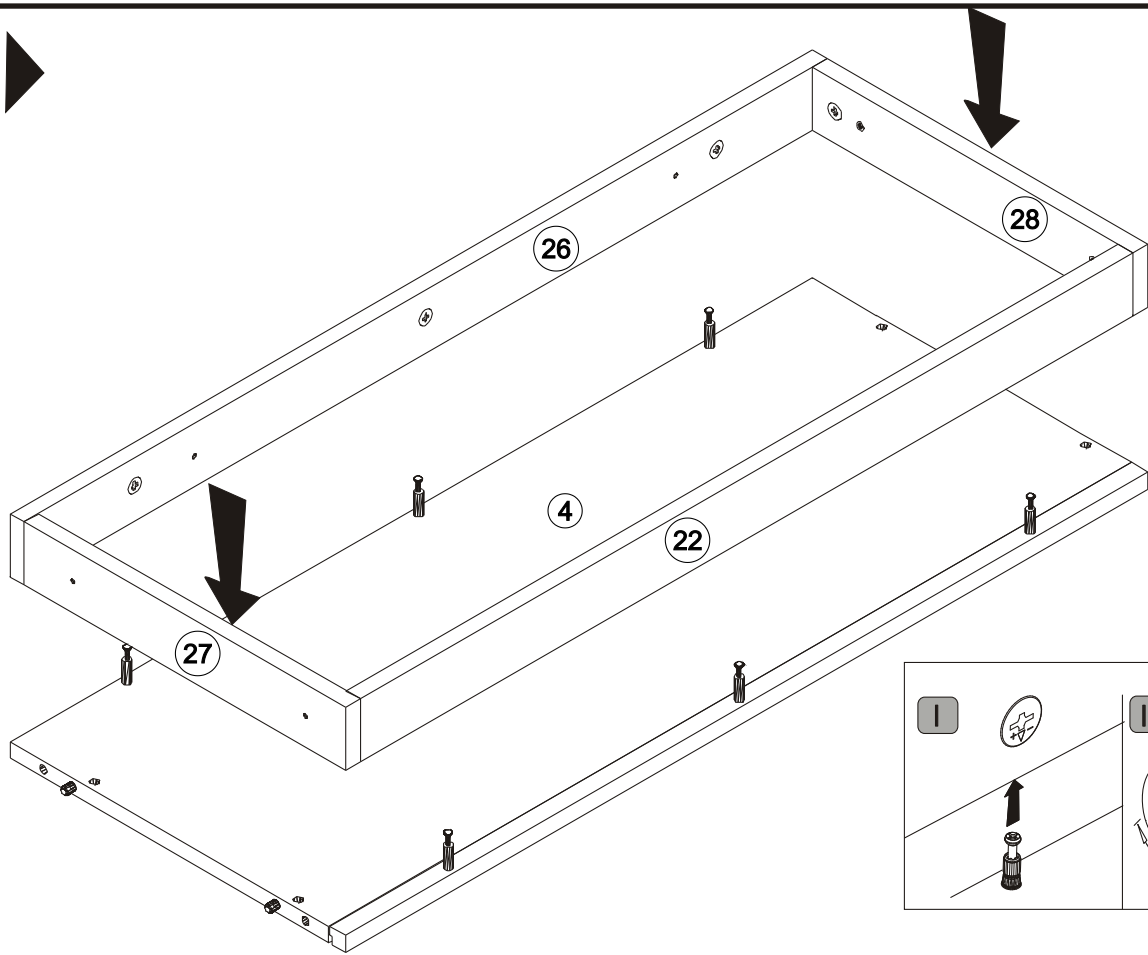

8 ▶

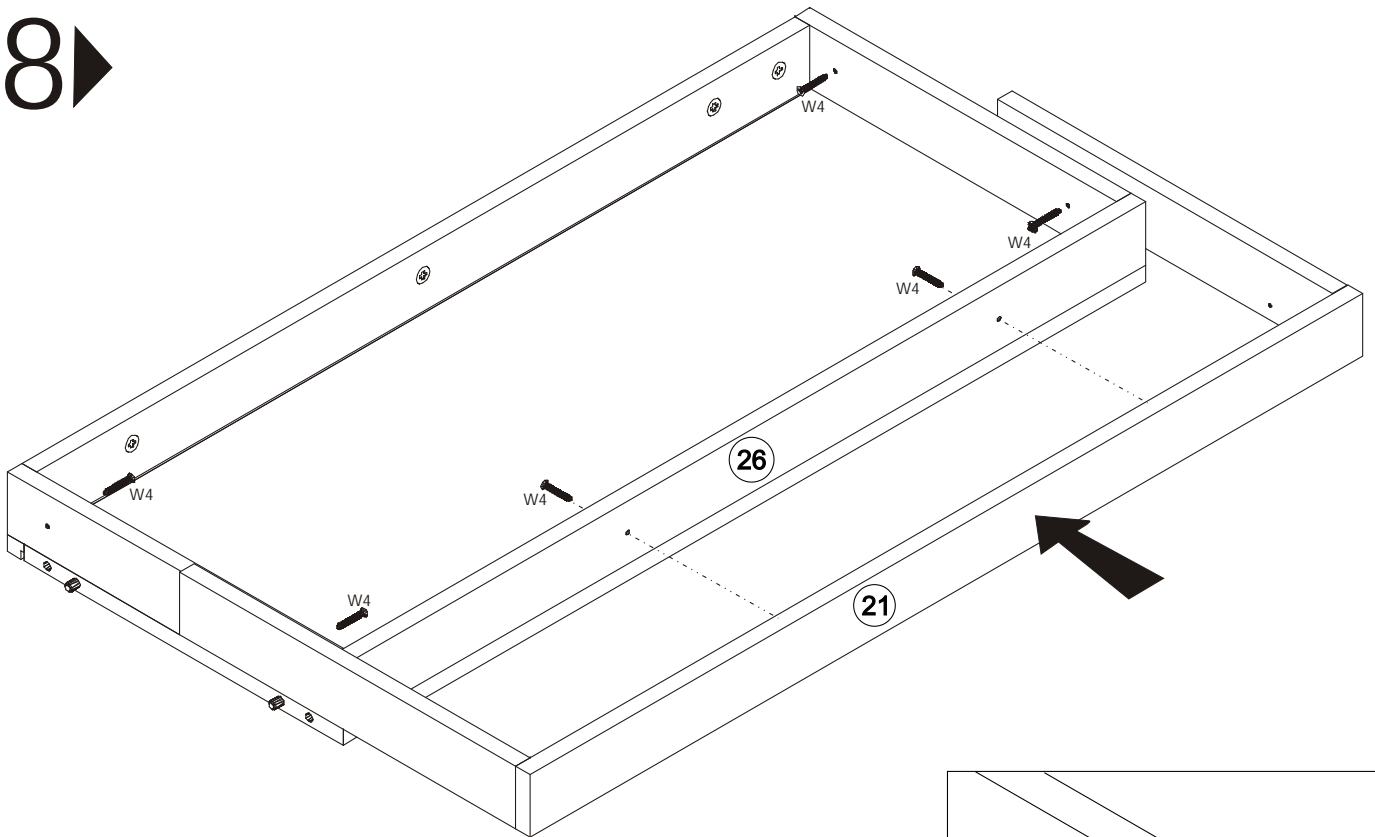

9 ▶

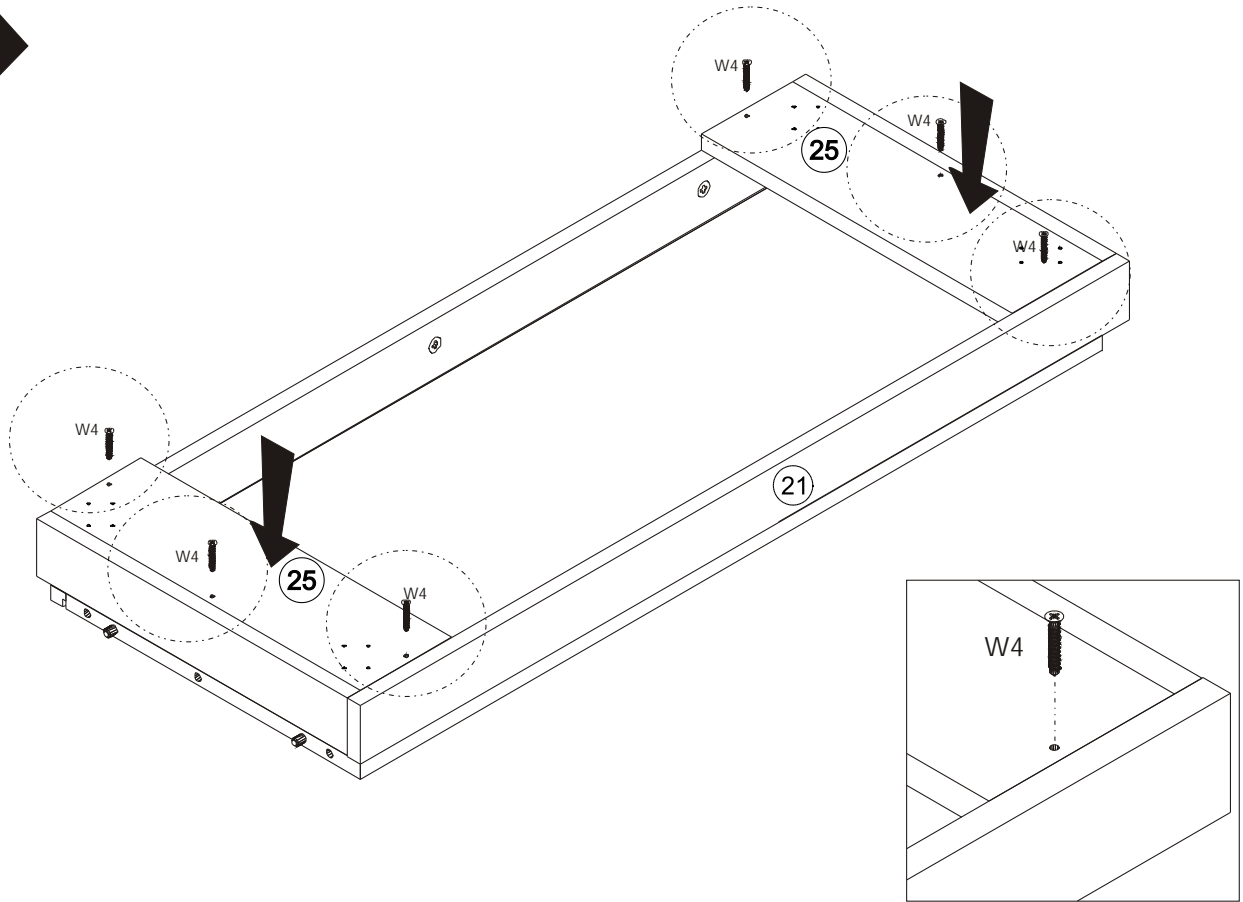

10 ▶

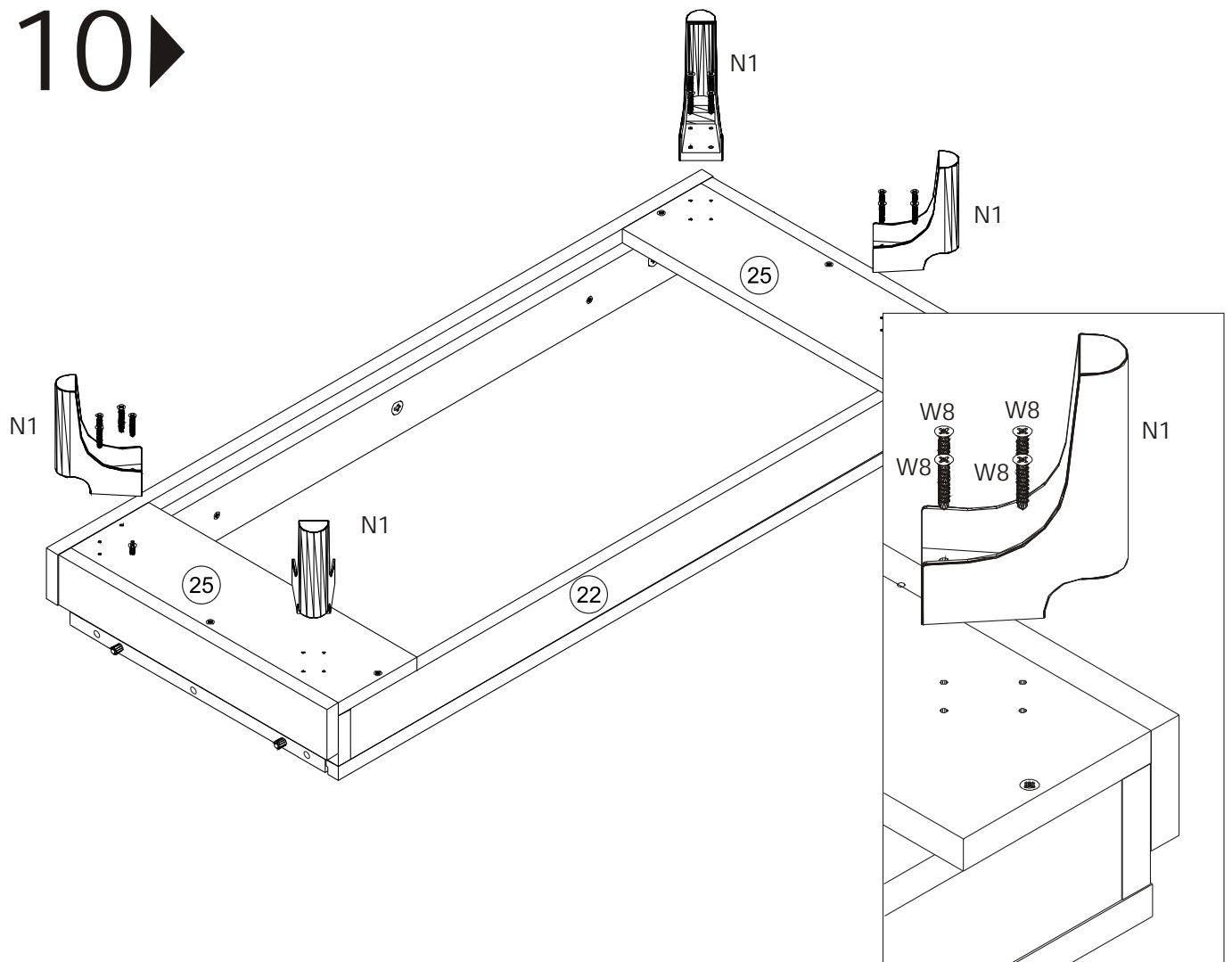

11 ▶

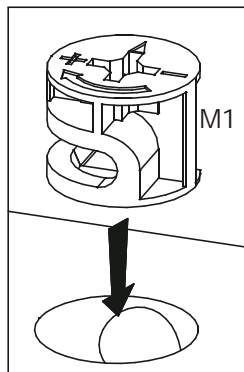
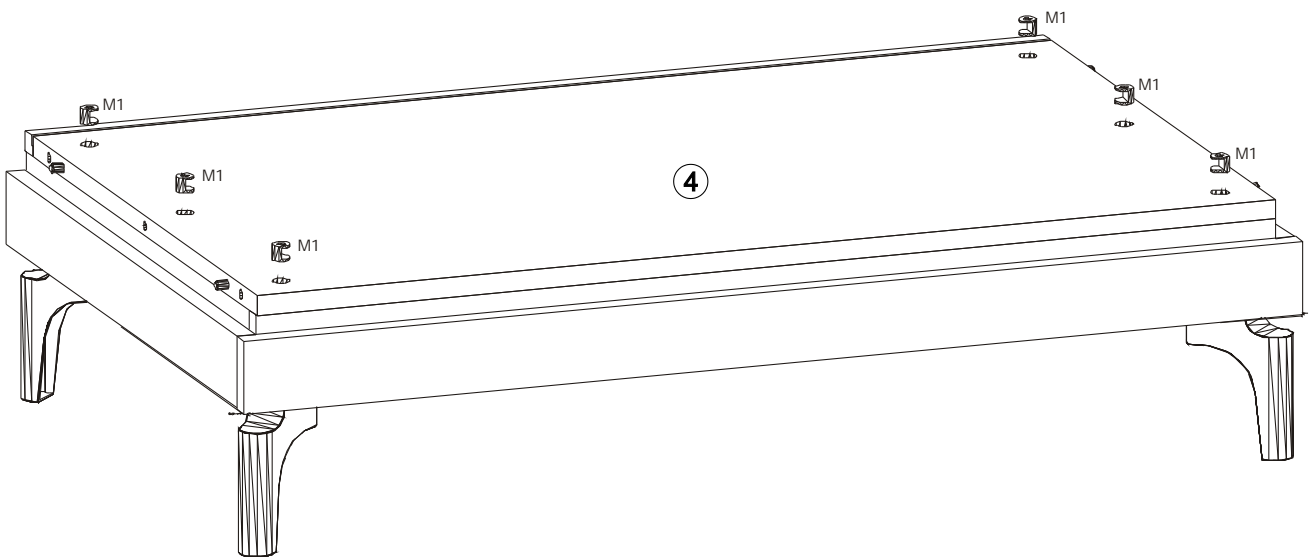

12 ▶

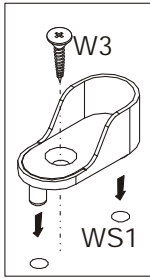
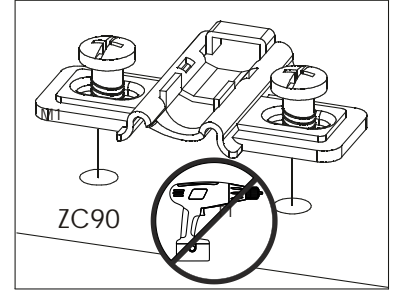
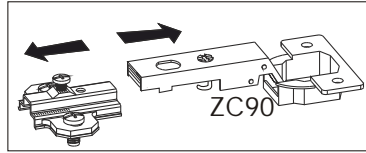

OPCJA(OPTION)LED

Podczas montażu wyźnicznika dotykowego należy dowiecĩa pokazany otwór wiertem $\Phi 12$ na przelot. Możliwoścã montażu z prawej lub lewej strony. Wierc'ic należyc z drugiej strony przyżożyc kawałek deski w celu zabezpieczenia przewiercanego elementu.

When installing the touch switch drill the hole shown with an $\Phi 12$ drill for the flight. Can be mounted on the right or left side. Drilling should be done from the other side put a piece of board over it to secure it drilled element.

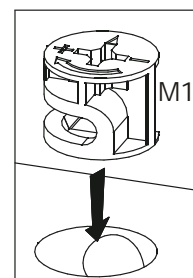
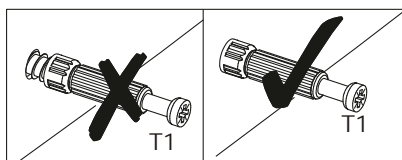
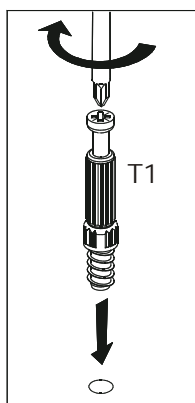
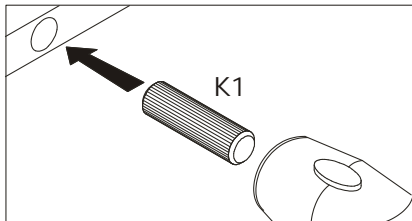
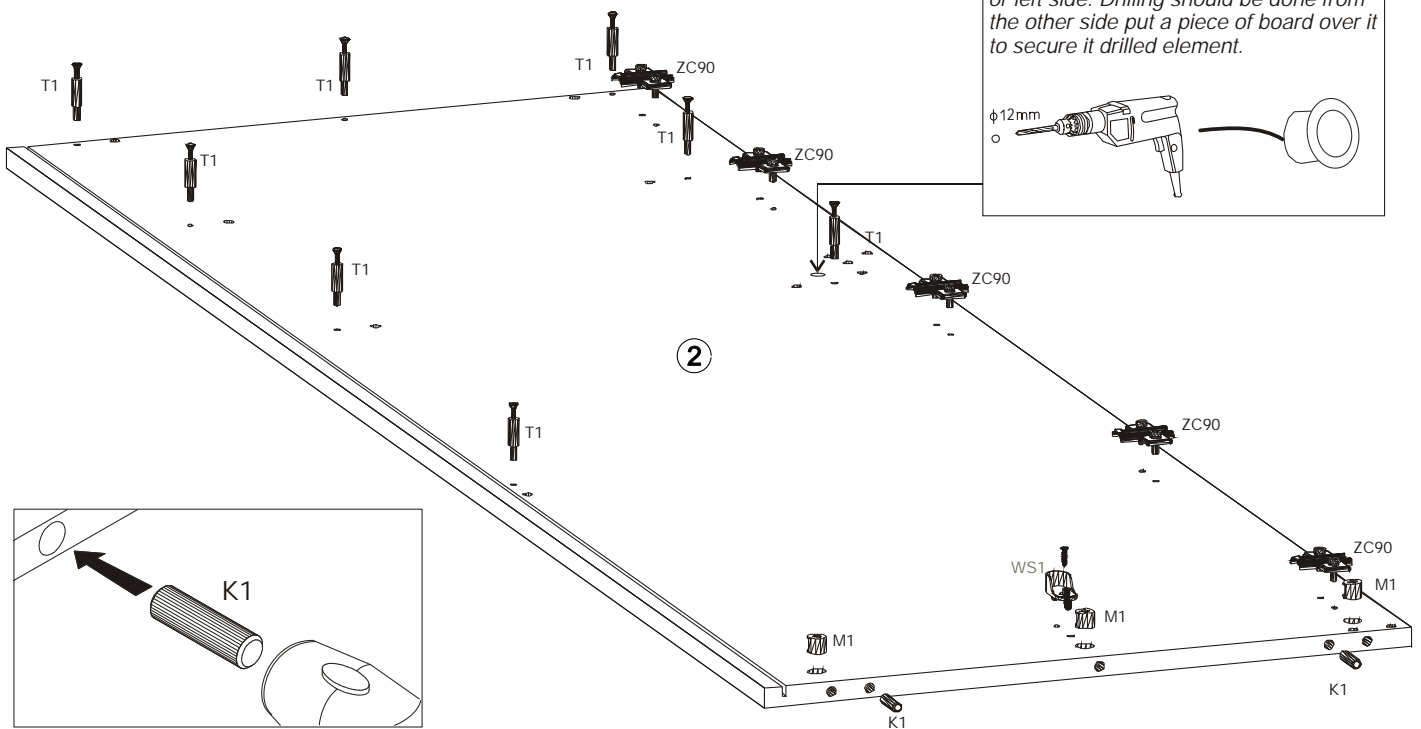
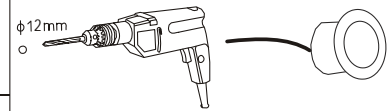

13 ▶

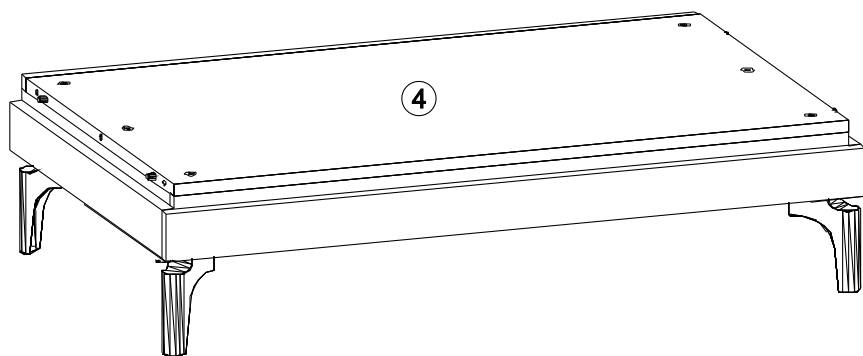
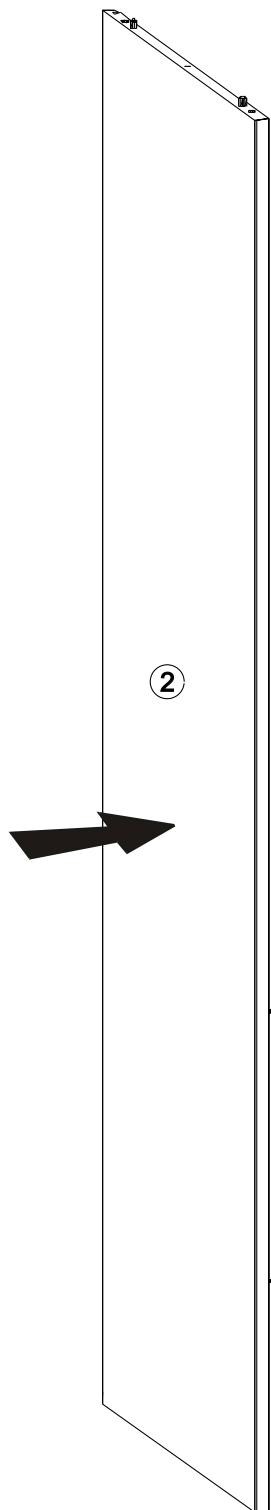

14

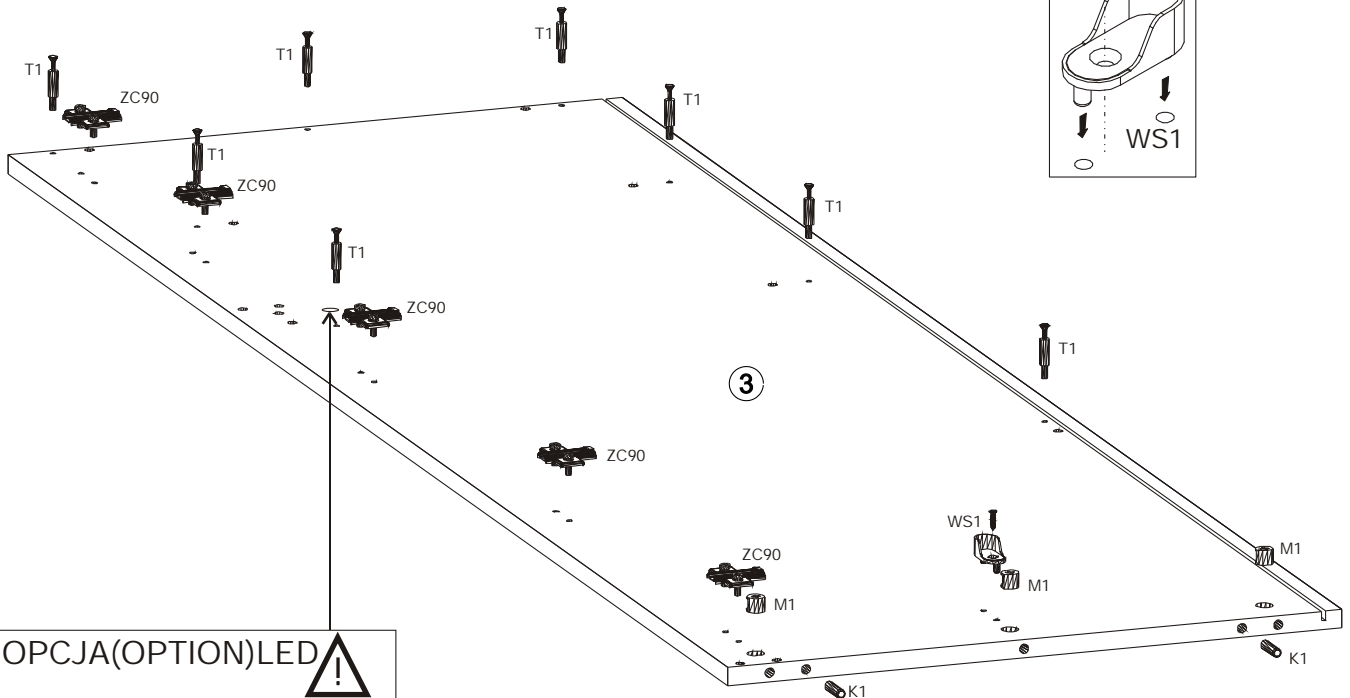
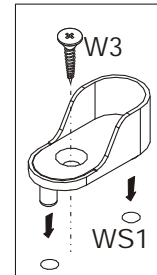
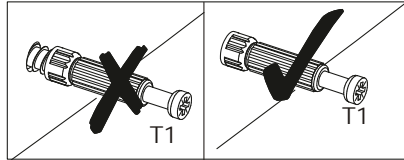
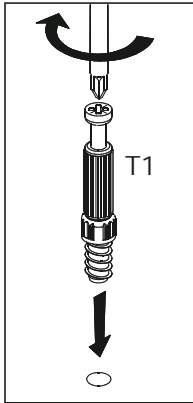
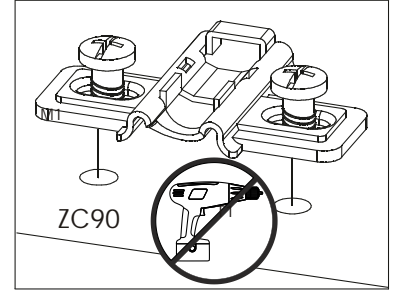
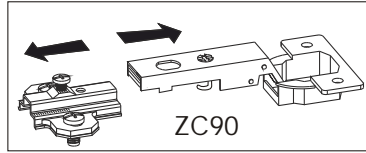

OPCJA(OPTION)LED



Podczas montażu wyłicznika dotykowego należy dowieźć pokazany otwór wiertłem $\Phi 12$ na przelot. Możliwość montażu z prawej lub lewej strony. Wiercić należy z drugiej strony przyłożą kawałek deski w celu zabezpieczenia przewiercanego elementu.

When installing the touch switch drill the hole shown with an $\Phi 12$ drill for the flight. Can be mounted on the right or left side. Drilling should be done from the other side put a piece of board over it to secure it drilled element.

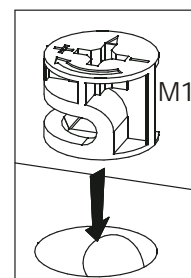
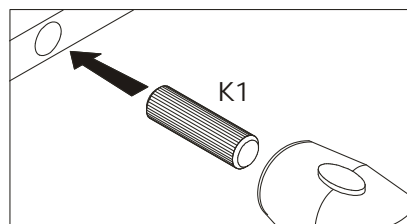
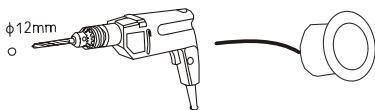

15 ▶

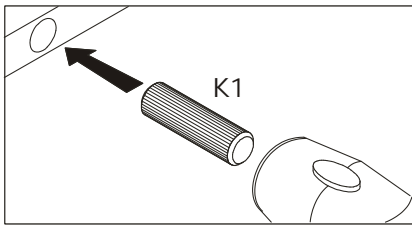
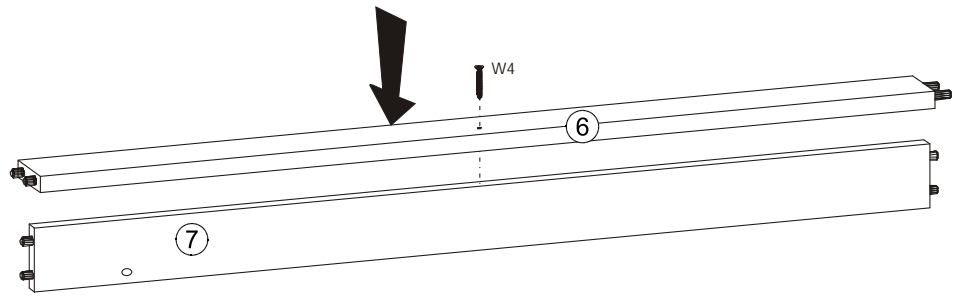
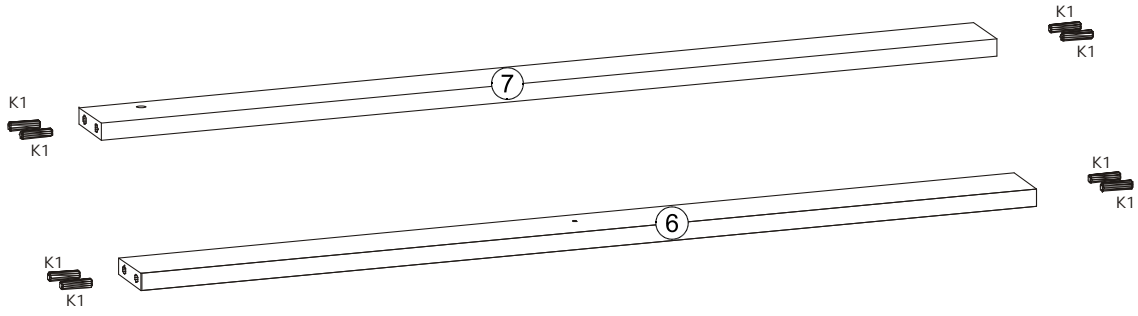

16 ▶

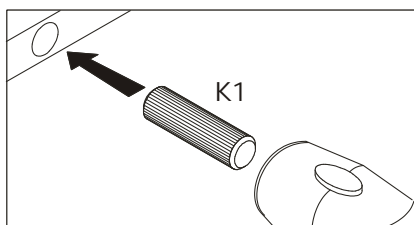
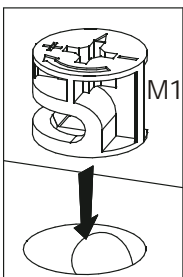
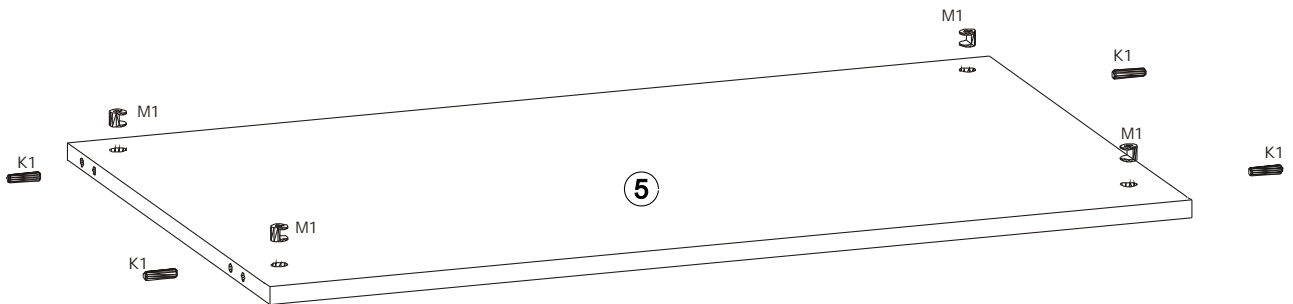

17 ▶

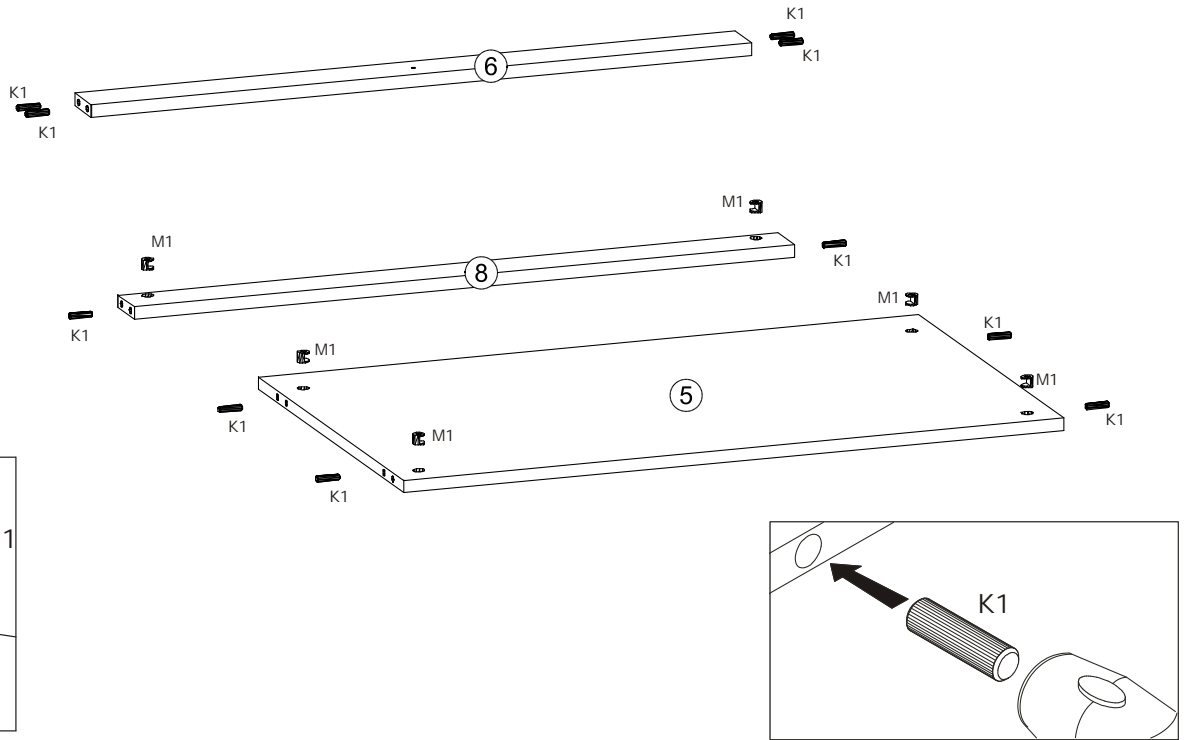

18 ▶

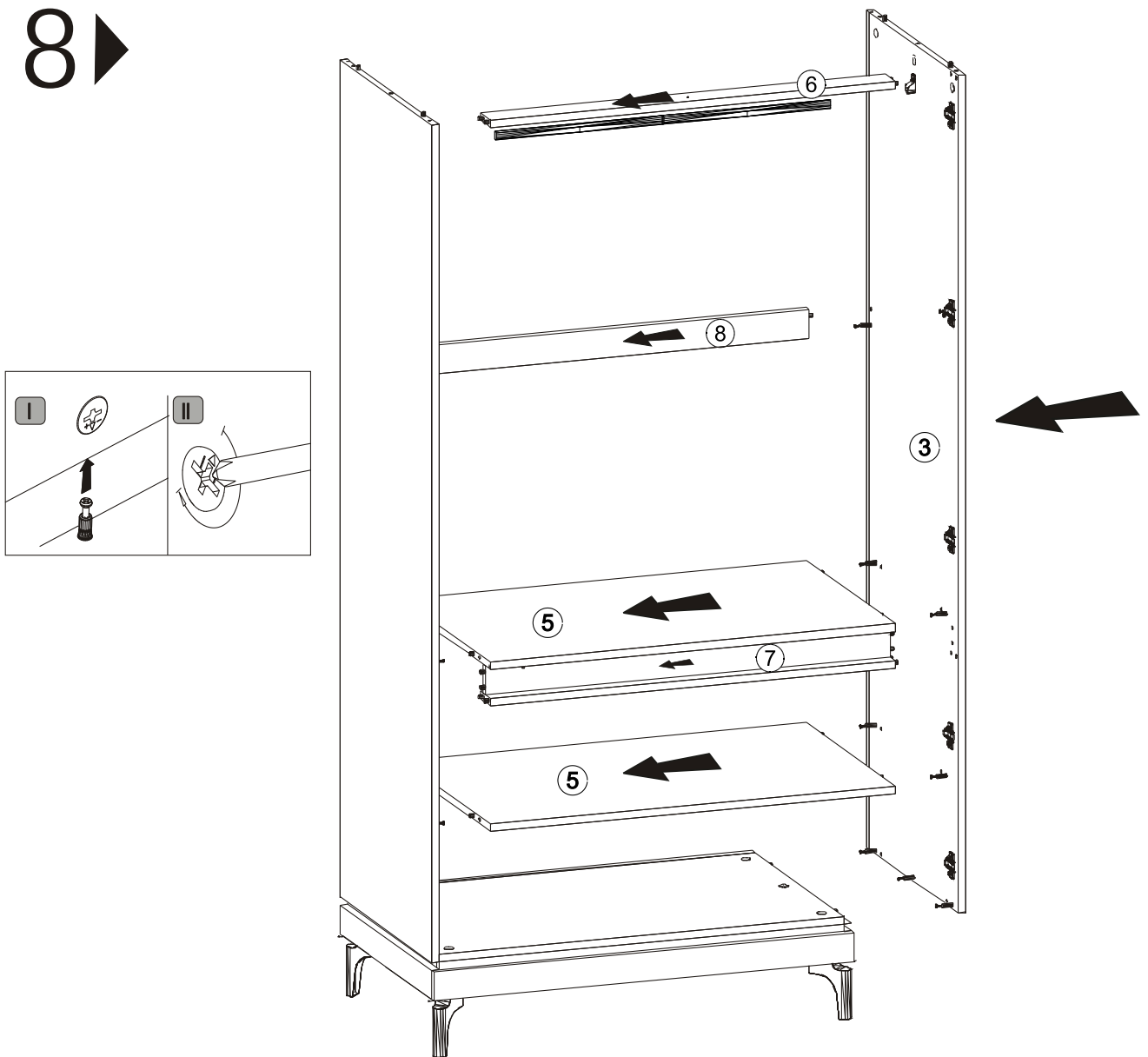

19 ▶

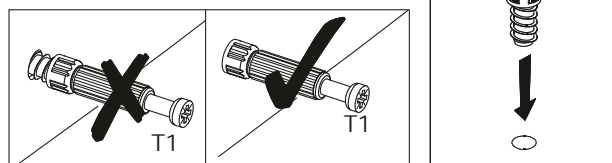
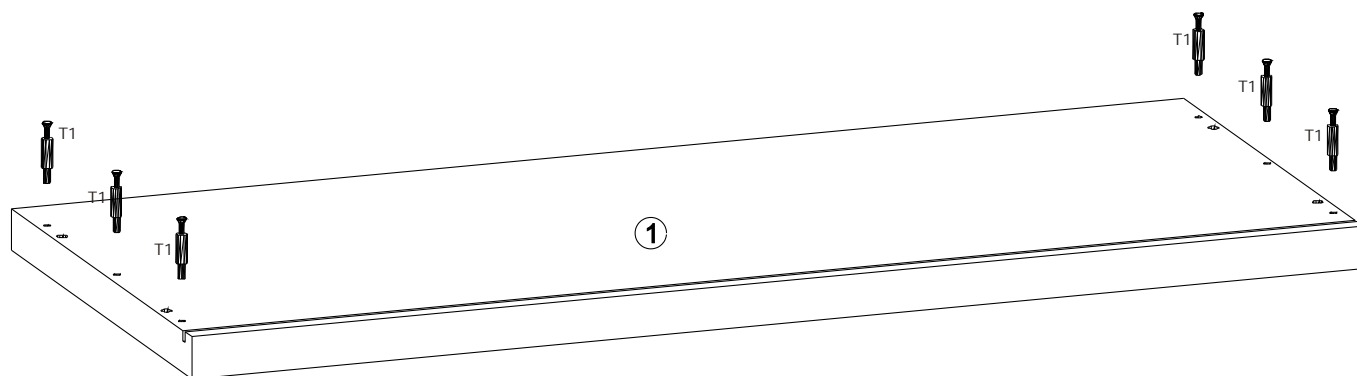

20 ▶

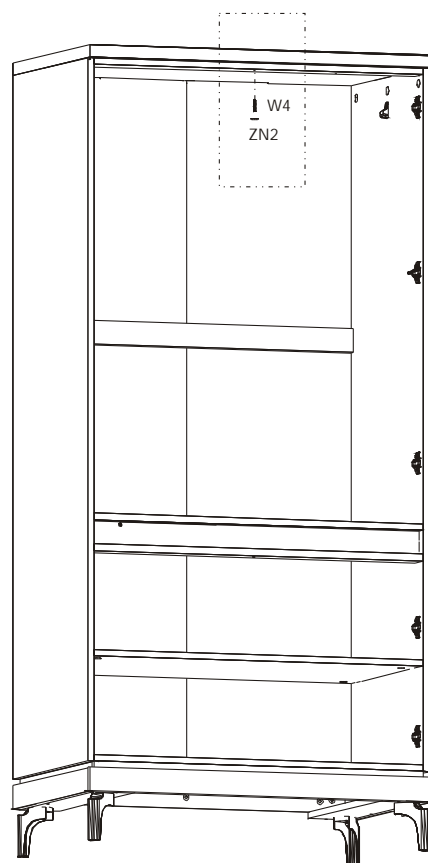
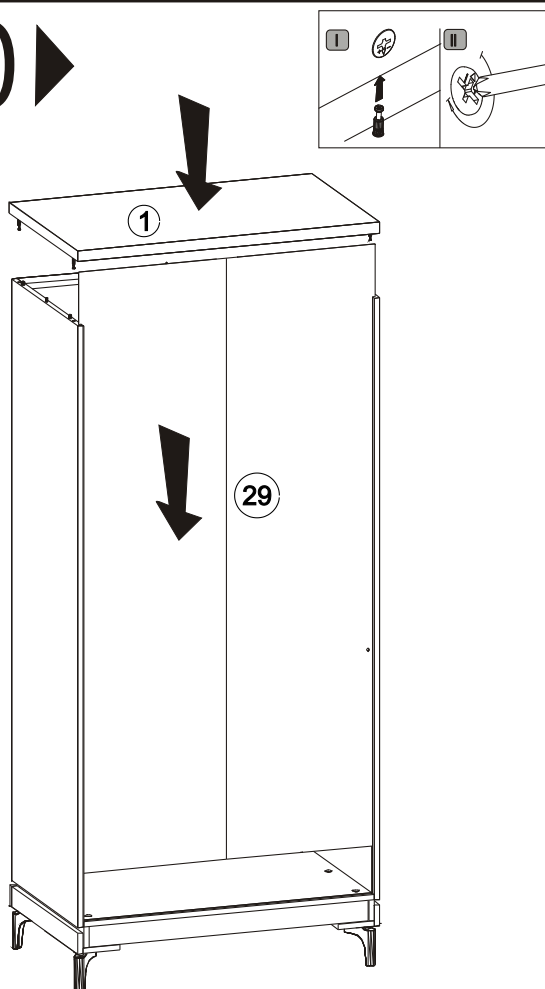

21 ▶

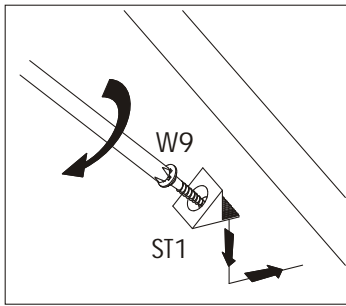
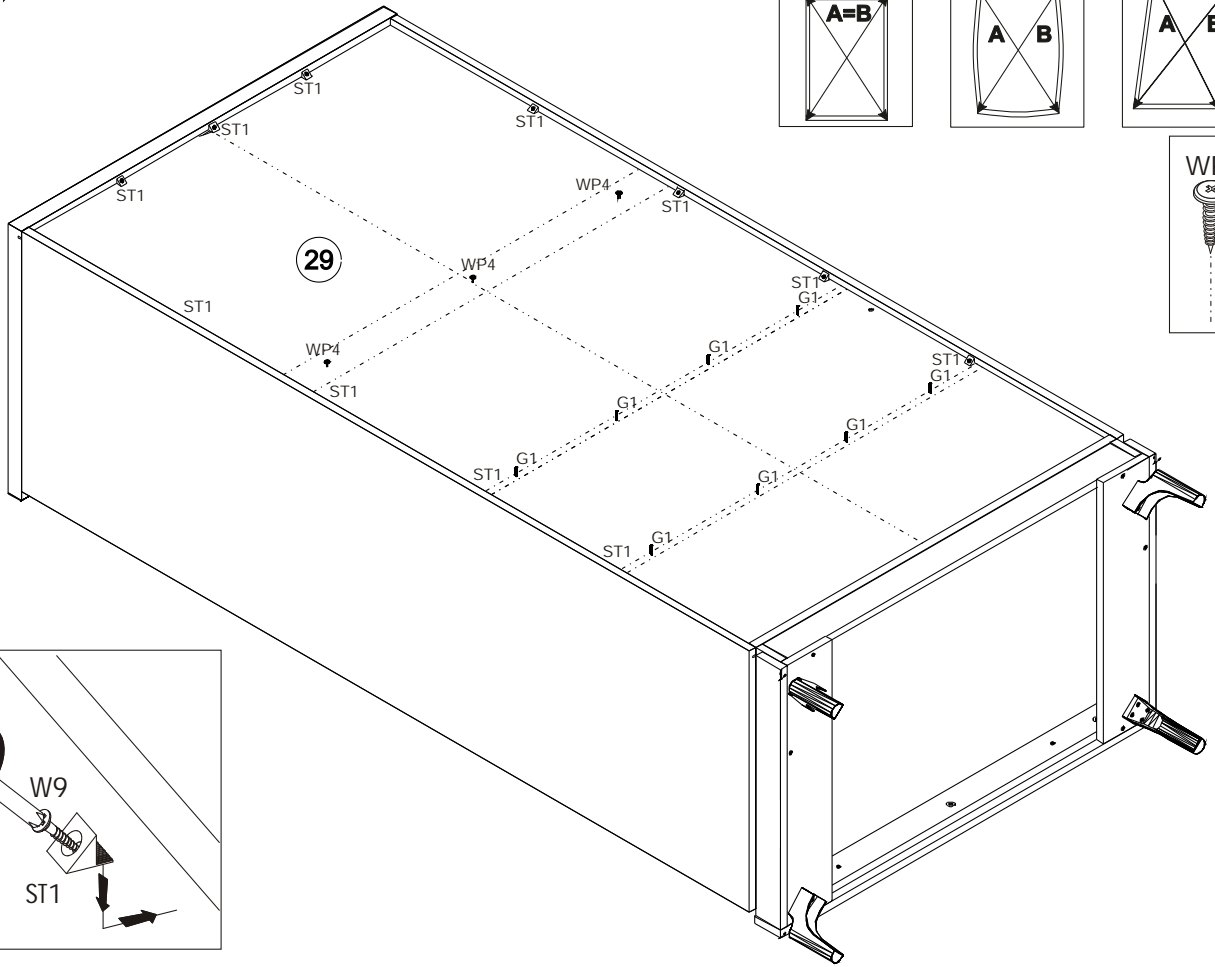
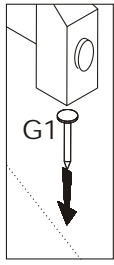

22 ▶

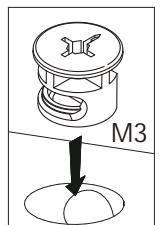
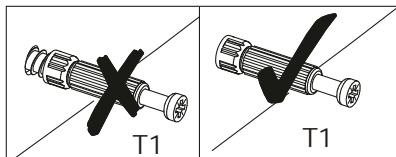
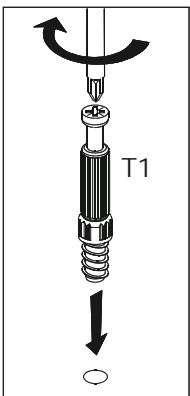
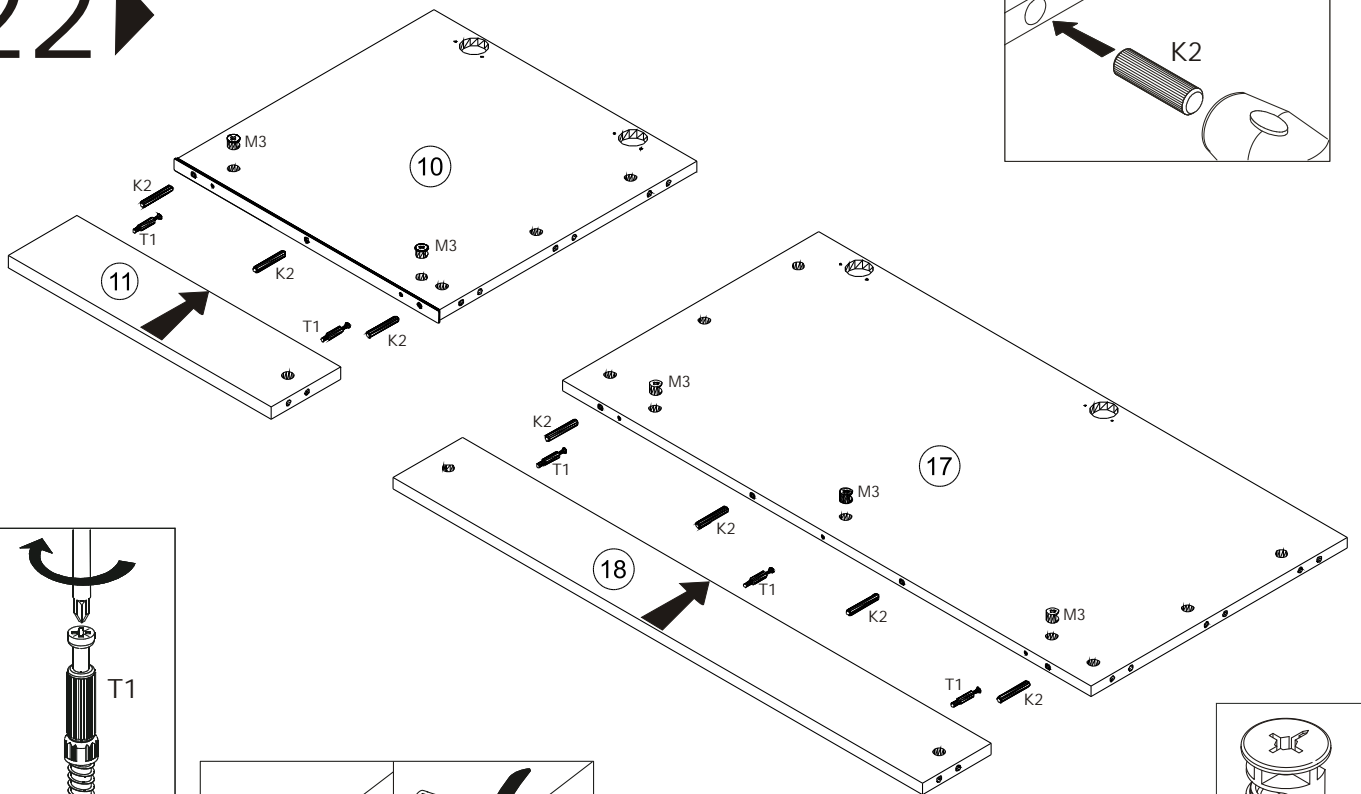
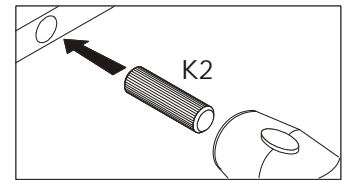

23 ▶

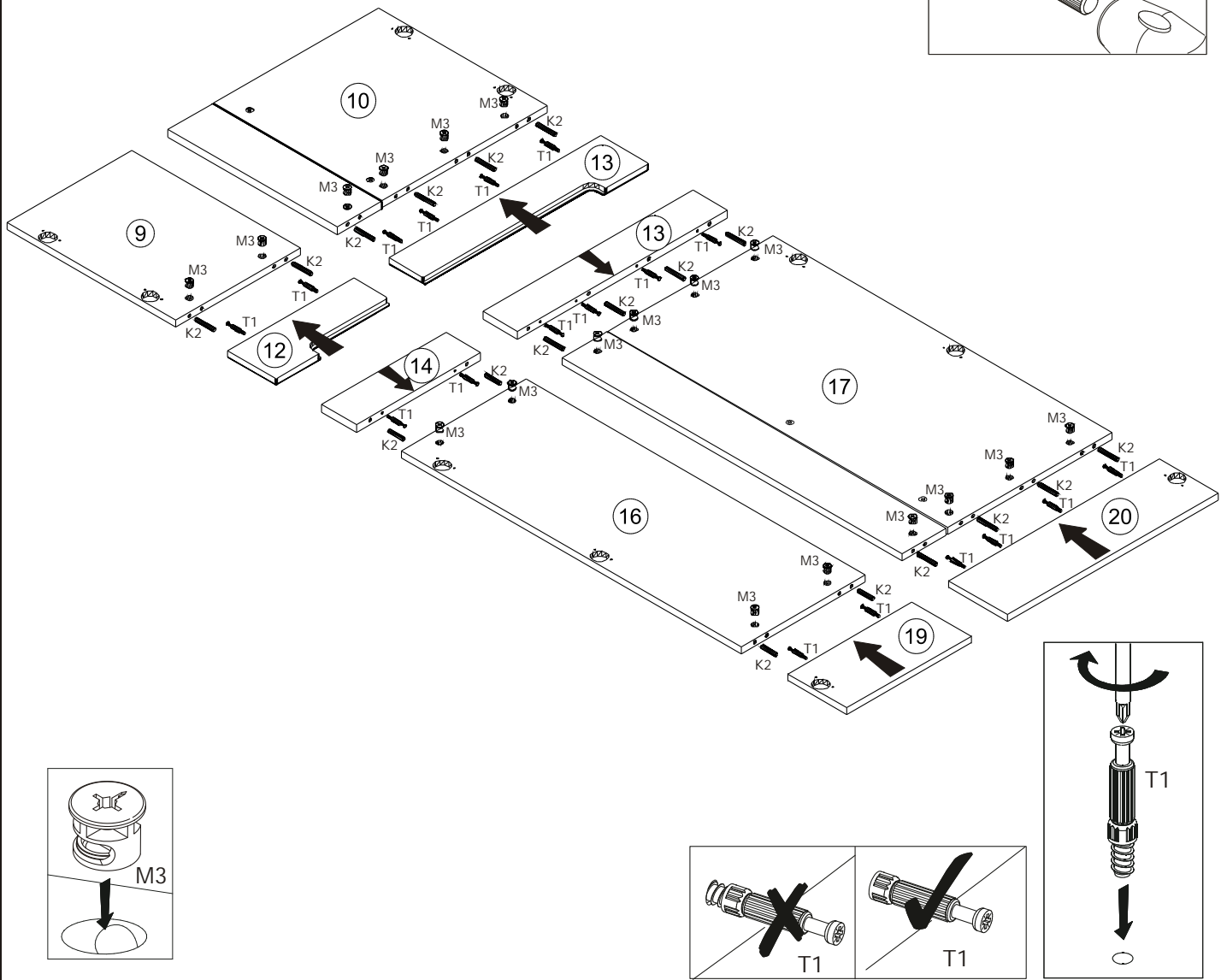

24 ▶

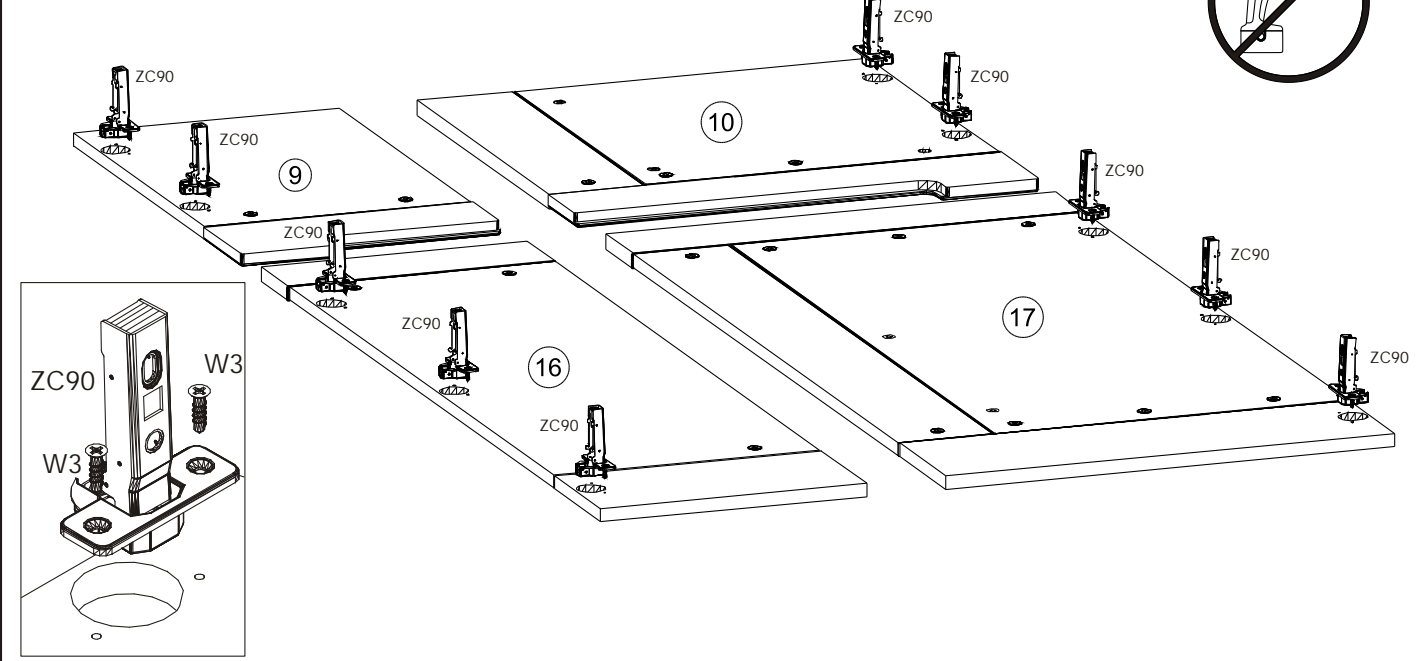

25 ▶

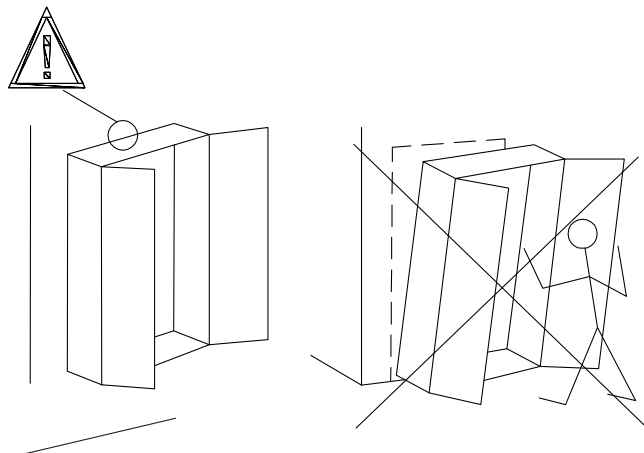
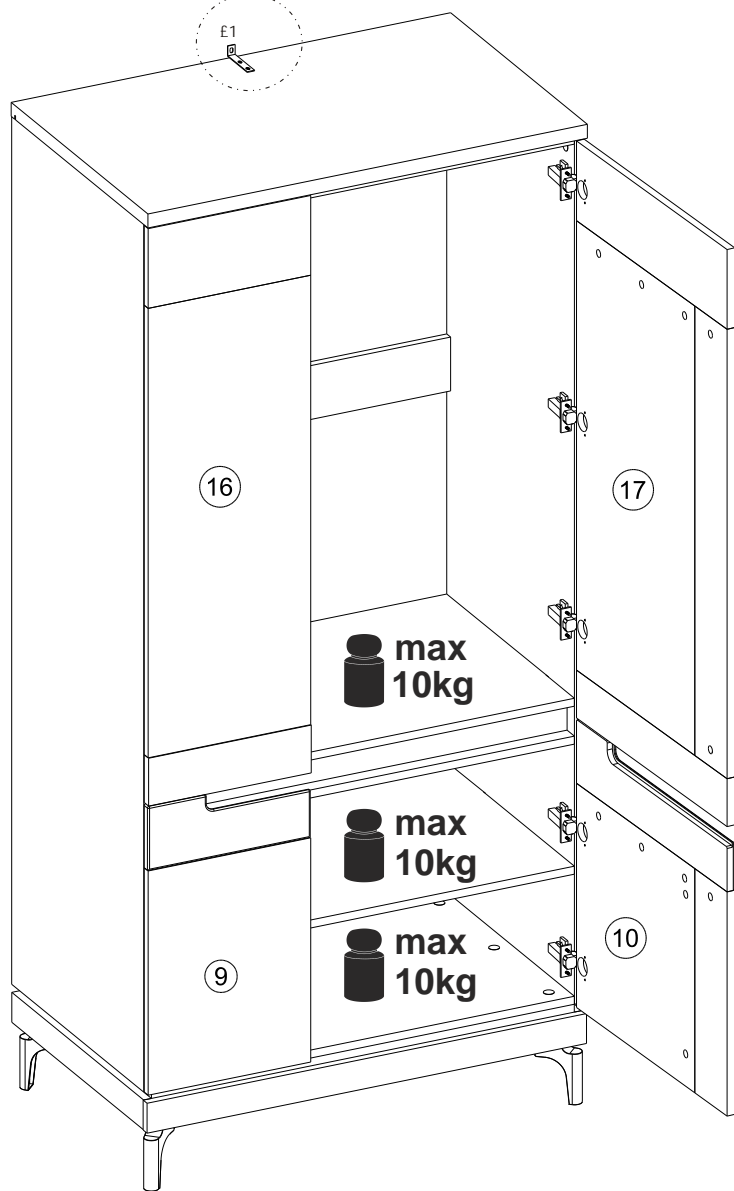
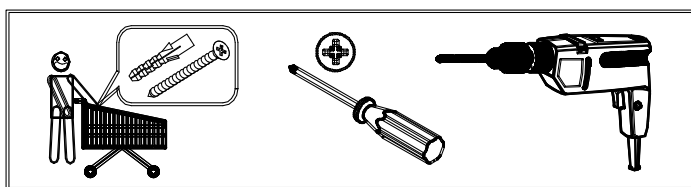
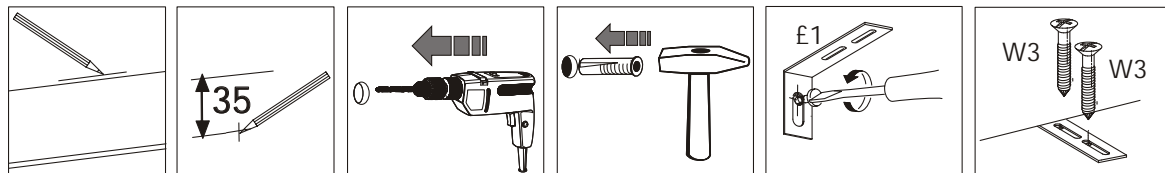

OPCJA(OPTION LED)

